

### PARTS LIST

#### Frame Stick

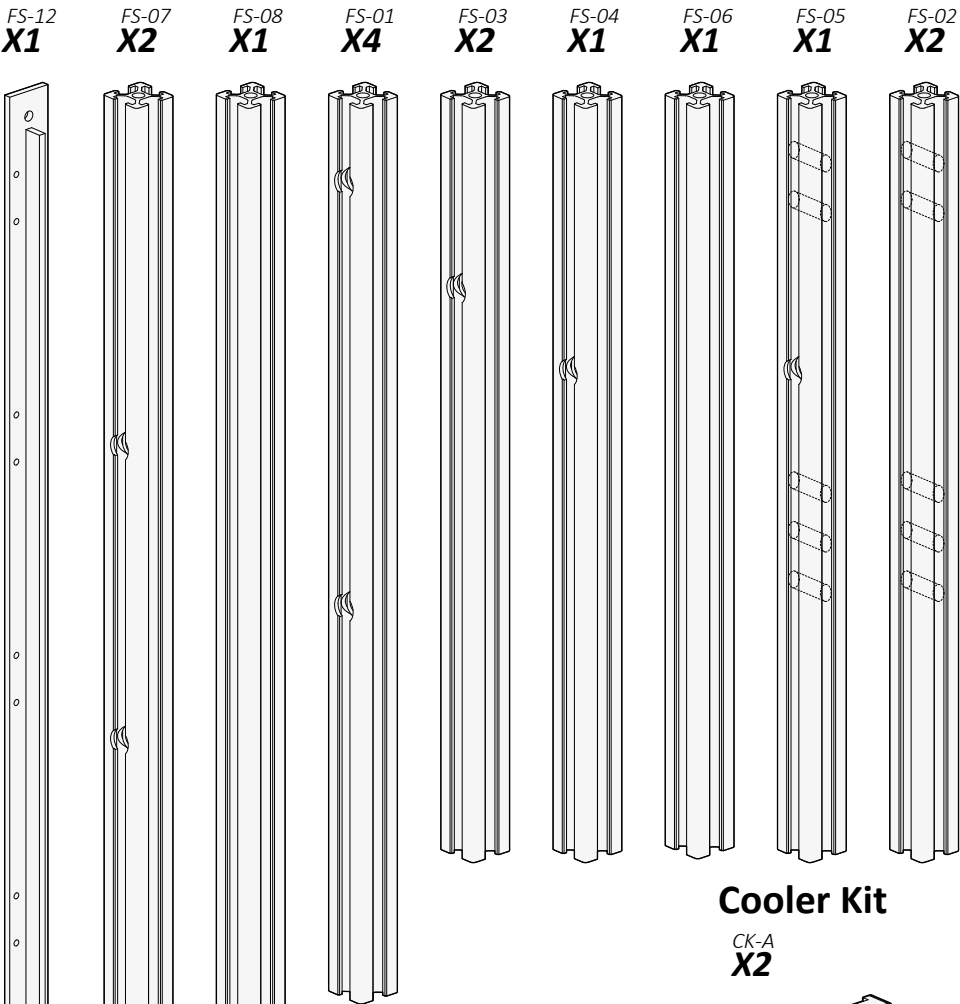

#### Accessory & Screw

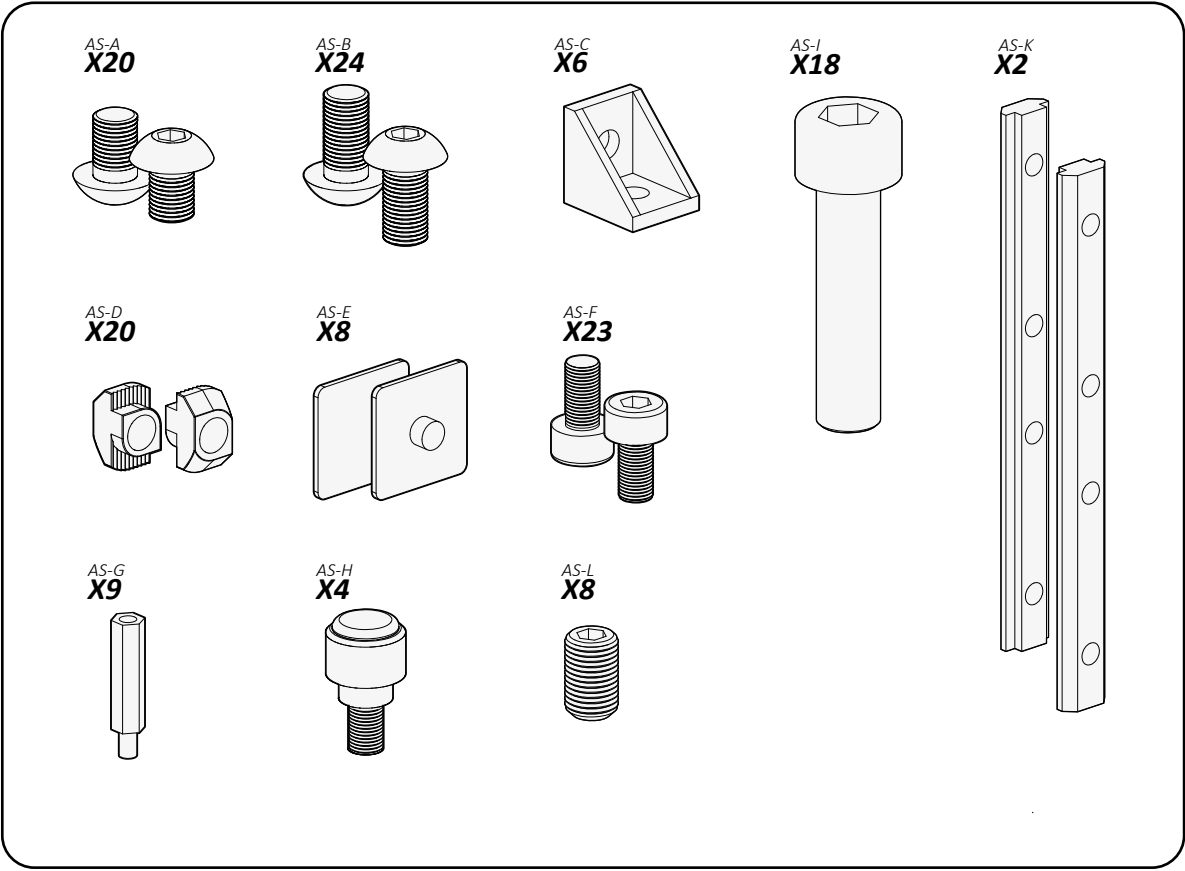

#### Cooler Kit

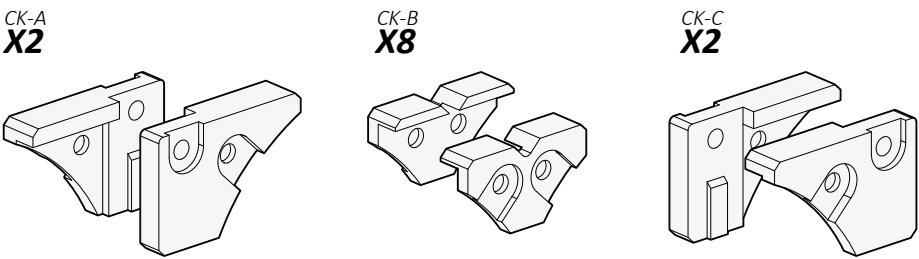

#### Disk Kit



#### Power Supply Kit

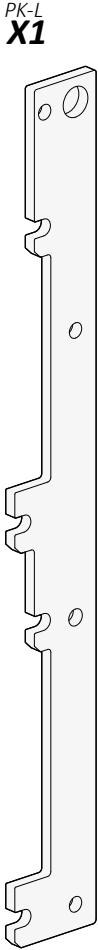

#### REAR VIEW

#### FRONT VIEW

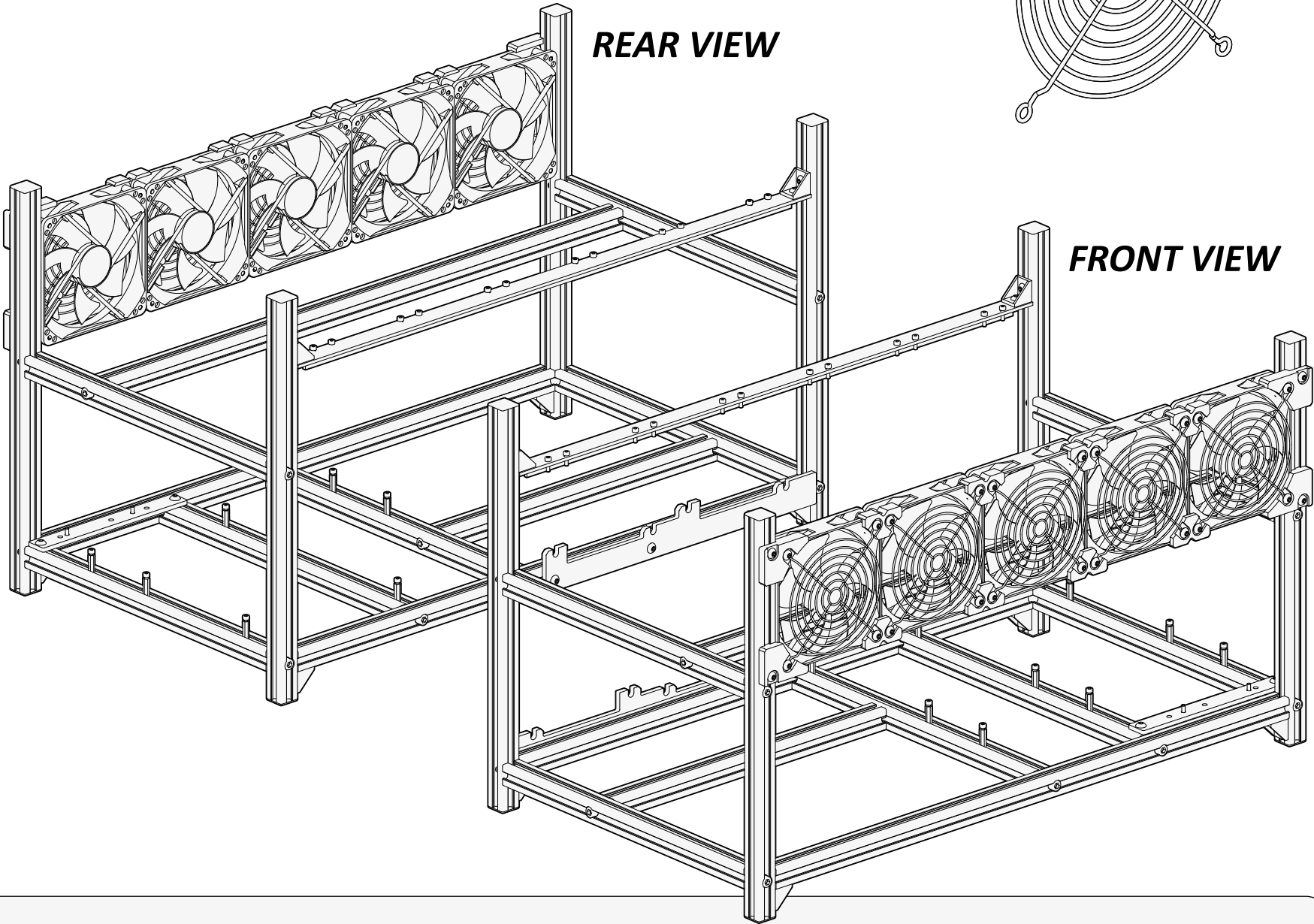

Please DO NOT remove the protect coat of frame sticks before you read this manual. The white lable on each packing can help you distingnish the number of frame sticks.

## Installation Manual

## OVERVIEW

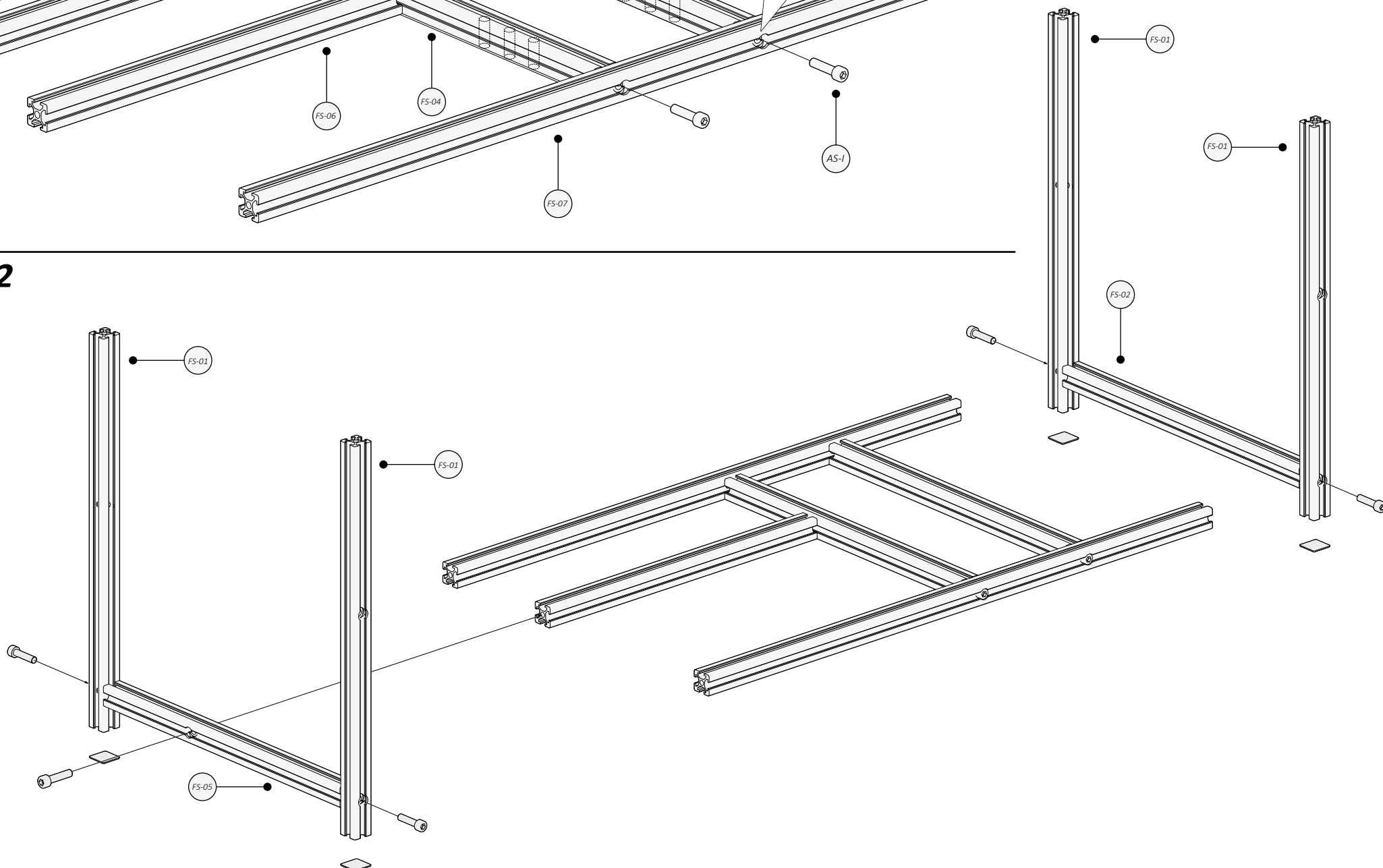

STEP 3

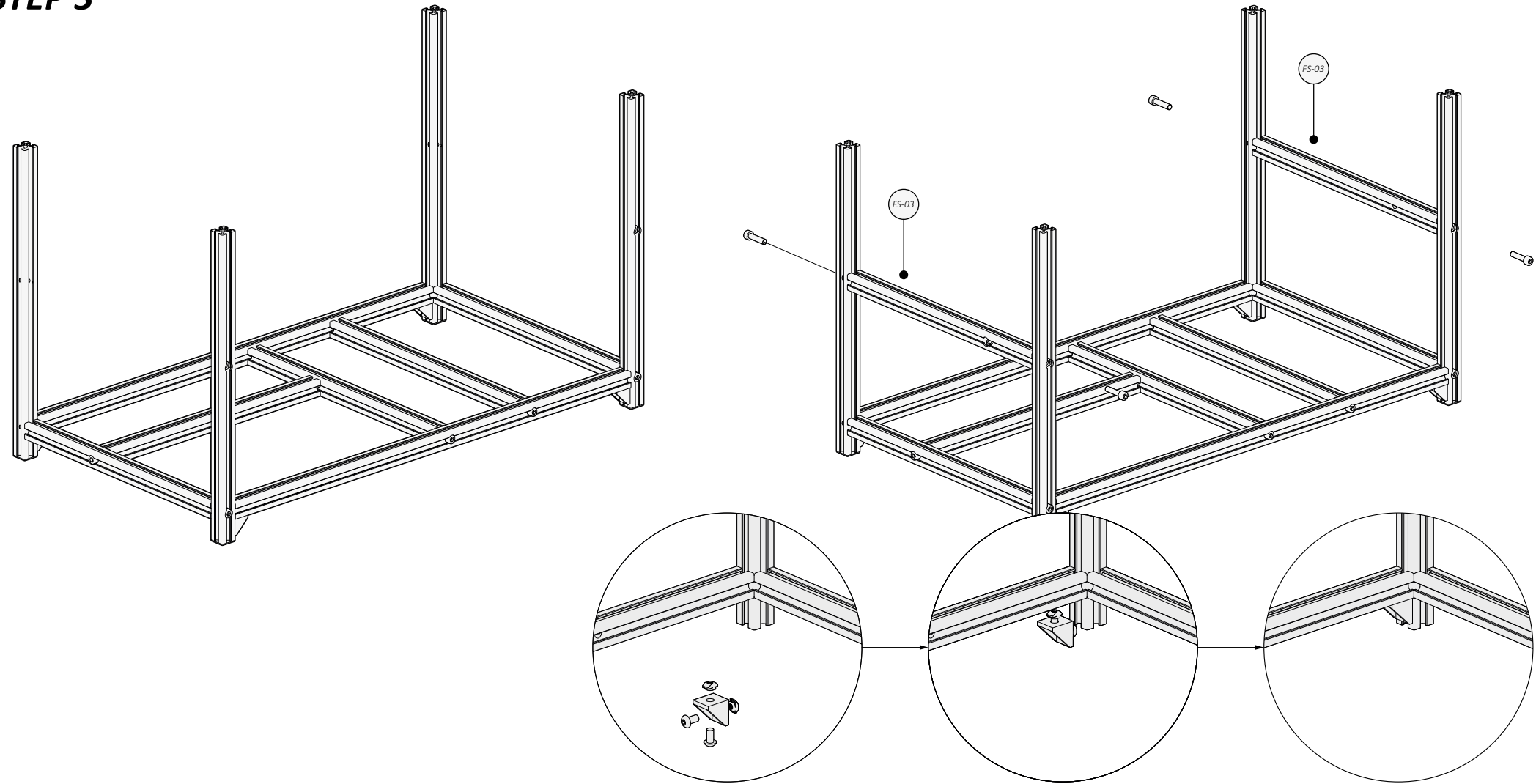

STEP 4

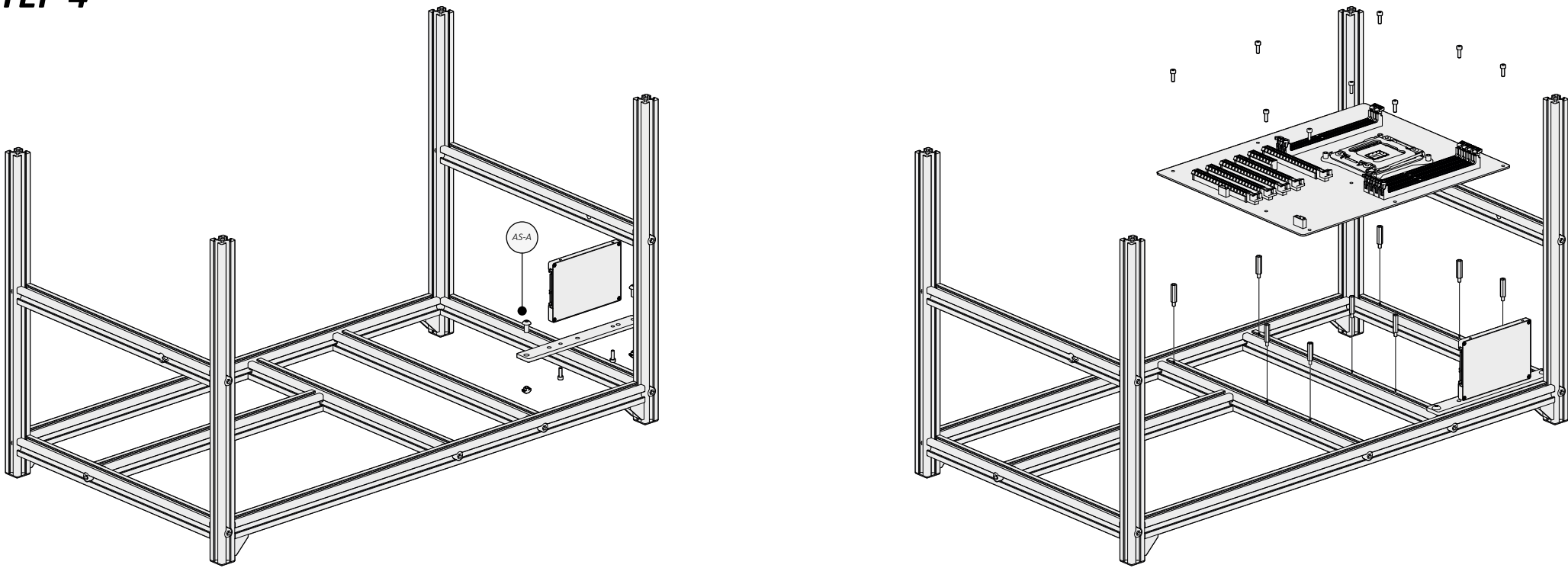

STEP 5

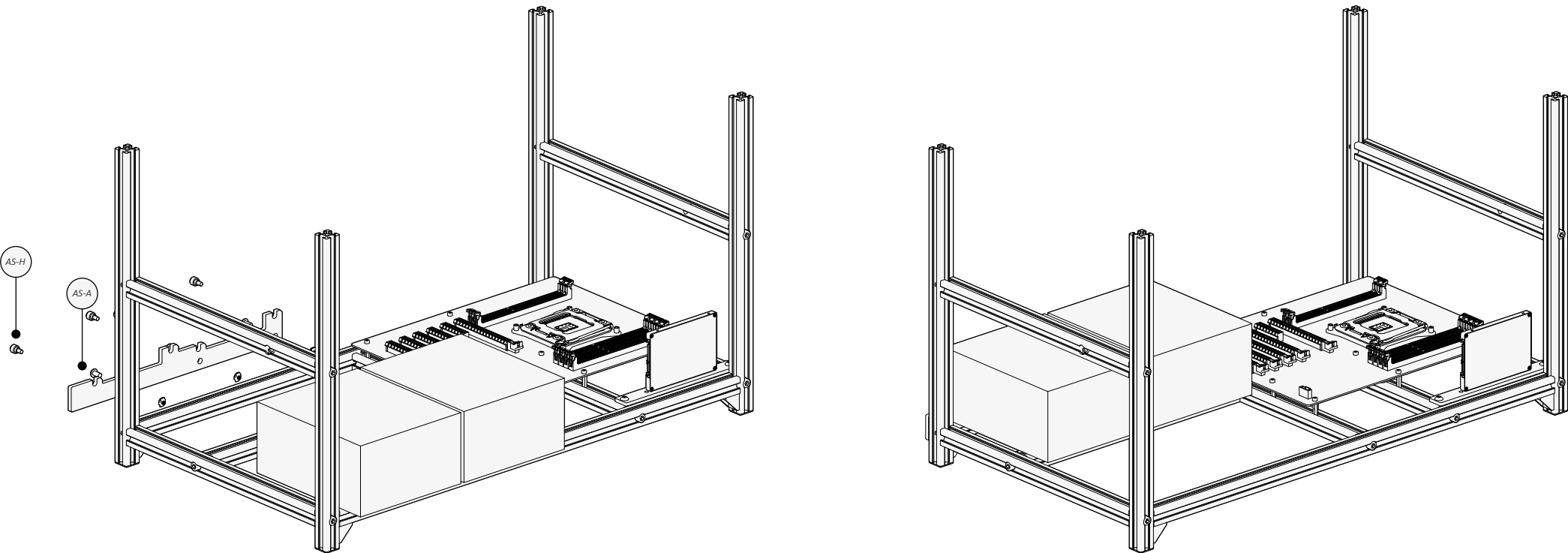



STEP 6

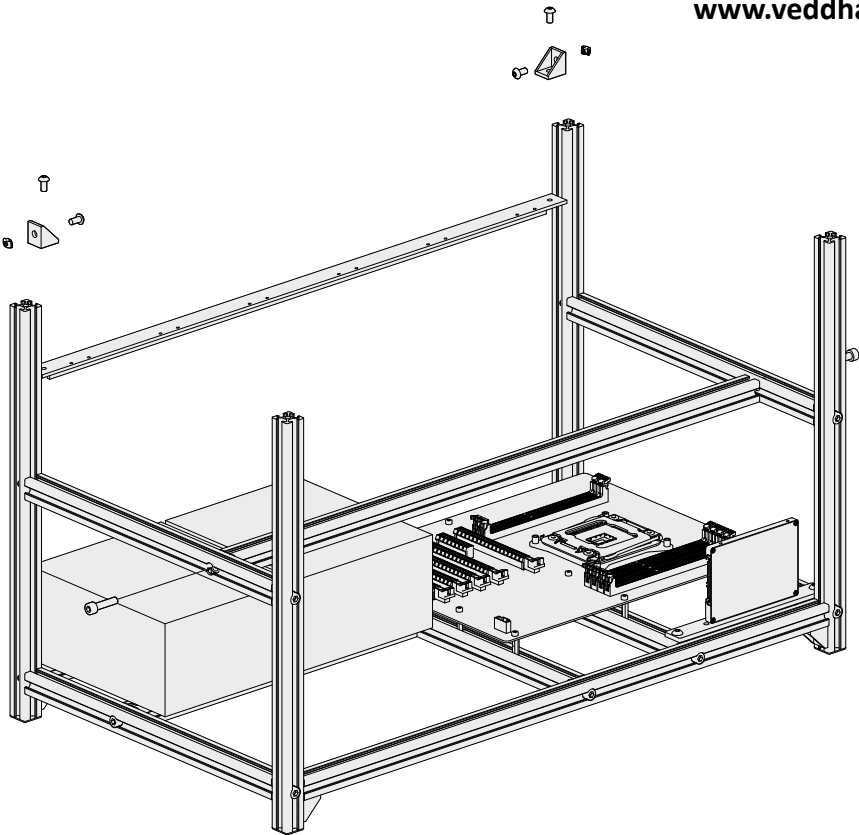
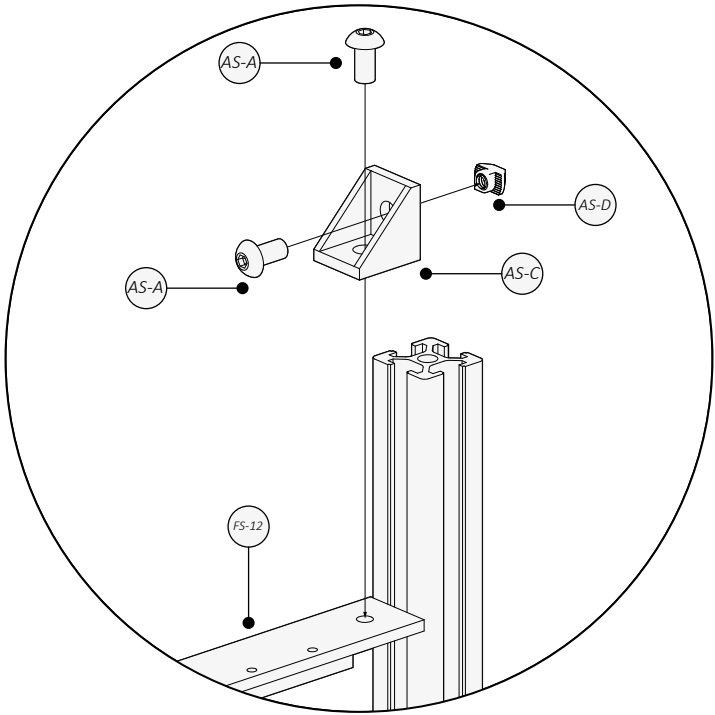

STEP 7

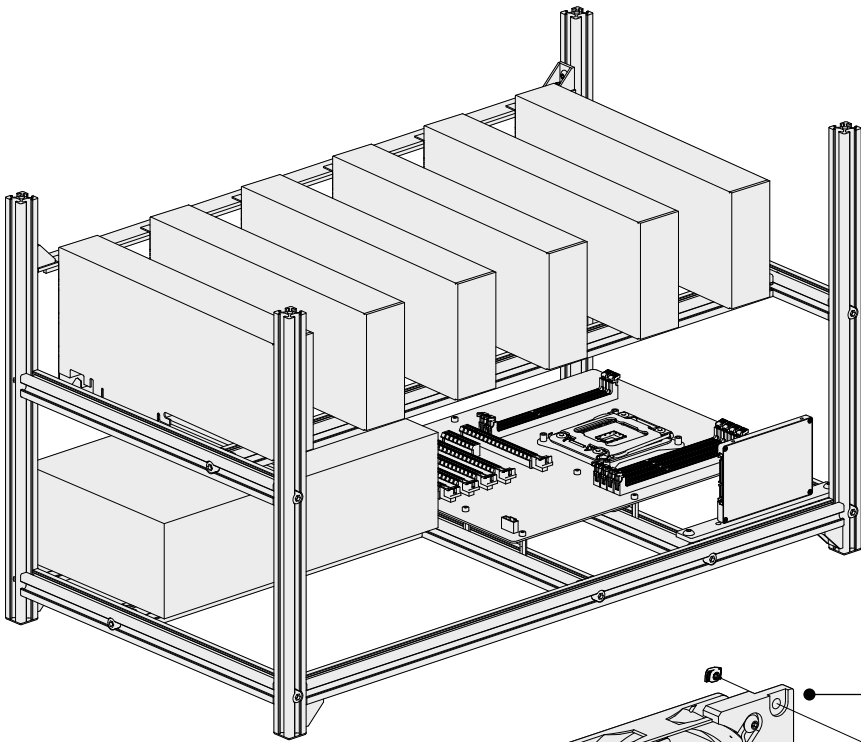
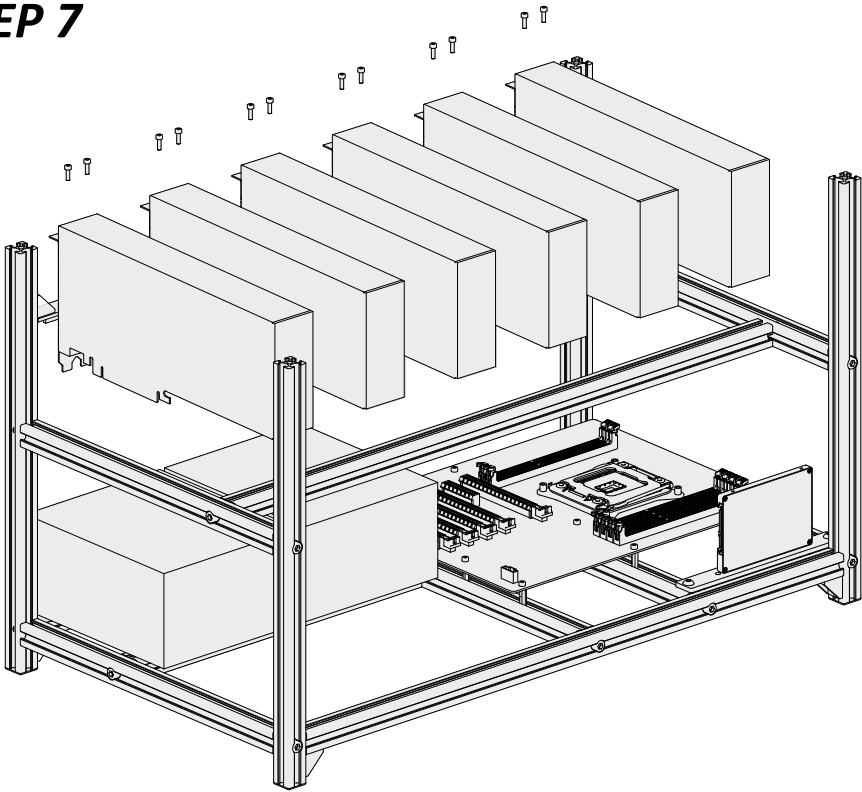

STEP 8

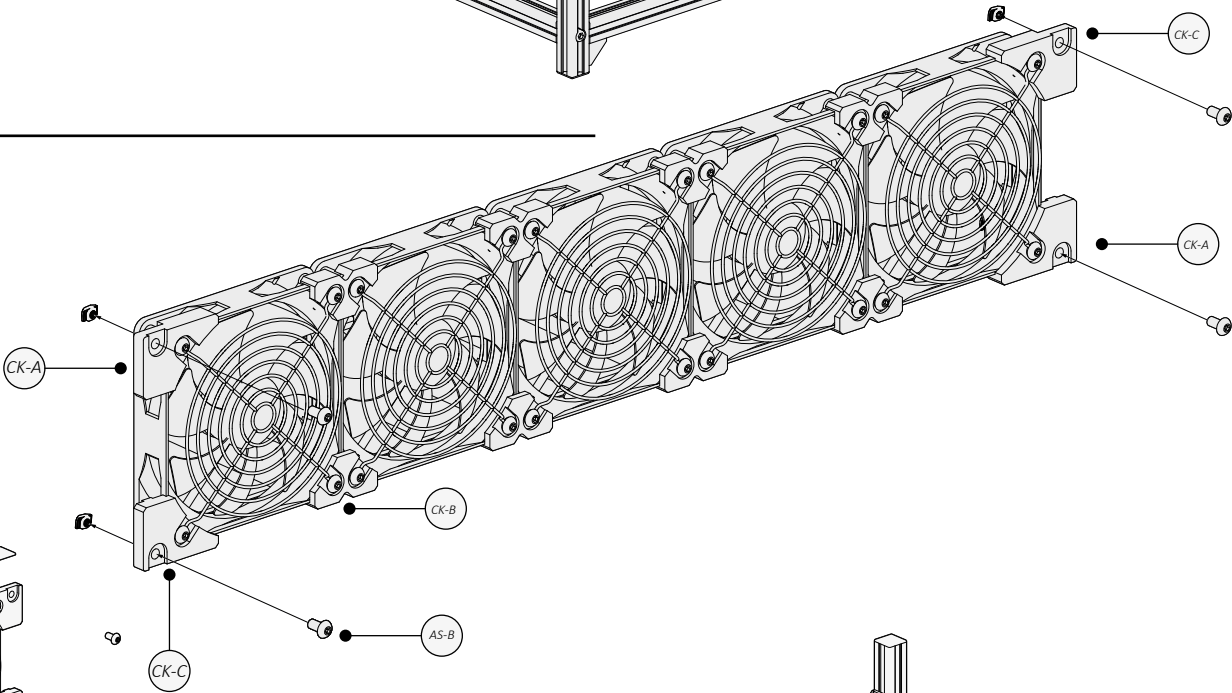

STEP 9

